

OVER 60?

Secure this property
for up to **59% less!**



Price
£280,000
Freehold

2x  1x  1x 

Woodhall Drive, Lake, Isle of Wight, PO36

Pittis 
Helping you move forwards



Main features

- Detached bungalow in quiet cul de sac location
- Conservatory overlooking the good sized rear garden
- Garage and parking to the side, solar panels on the roof
- Modern kitchen and wet room
- Recently installed boiler connected to central heating

Accommodation

GROUND FLOOR

Hallway
 Lounge/Dining Room: 19'2 x 11'1 (5.85m x 3.38m)
 Conservatory: 10'4 x 7'0 (3.15m x 2.14m)
 Kitchen: 8'9 x 6'4 (2.67m x 1.93m)
 Bedroom 1: 11'5 x 9'0 (3.48m x 2.75m)
 Bedroom 2: 8'11 x 7'8 (2.72m x 2.34m)
 Shower Room

OUTSIDE

Garage & Driveway
 Front & Rear Gardens
 Greenhouse

Ground Floor

Approx. 60.7 sq. metres (653.3 sq. feet)

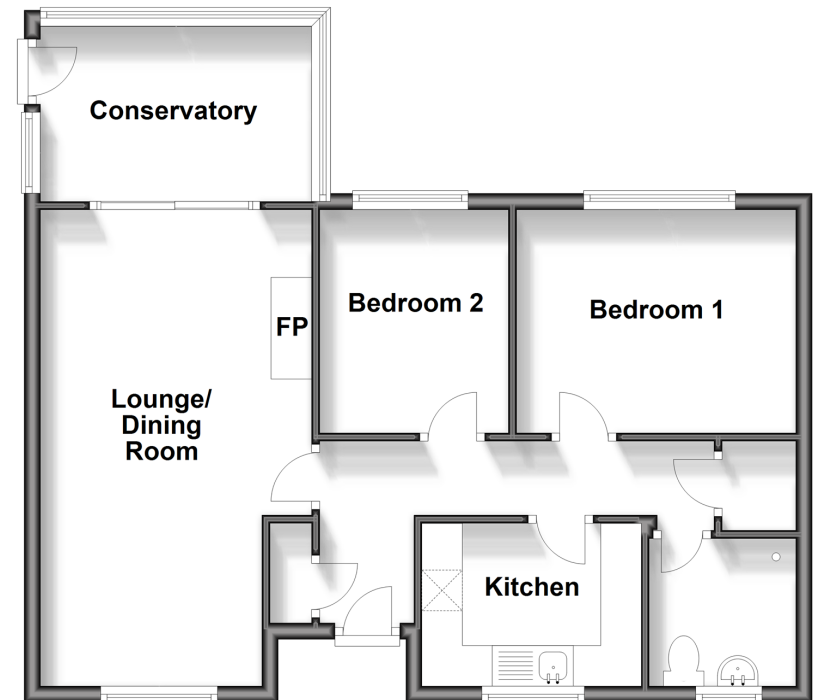

Call Shanklin - 01983 868777 ■ pittis.co.uk

■ Legal advice should be taken to verify fixtures/fittings, planning, alterations and/or lease details
 ■ Through a Homewise Home For Life Plan people aged 60+ can secure this property for up to 59% less, by purchasing a Lifetime Lease.

■ Appliances & services are untested, dimensions are approximate and floor plans are not to scale

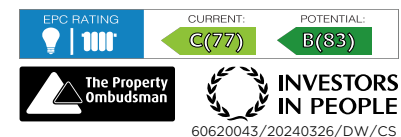

60620043/20240326/DW/CS