



Price

£108,000

Leasehold

3x  1x  1x 

**Coronation Close,
Aylesham, Canterbury,
Kent, CT3**

cubitt & west
Helping you move forwards



Main features

- Spacious entrance hall with access to first floor
- Separate bright and comfortable living room
- Modern family bathroom
- Allocated parking space
- Private rear garden
- Large kitchen-dining area



Accommodation

GROUND FLOOR

Entrance Hall
 Living Room : 13'8 x 13'2 (4.17m x 4.02m)
 Downstairs W/C
 Kitchen/ Dining : 16'9 x 10'2 (5.11m x 3.10m)

FIRST FLOOR

Bedroom 1 : 16'10 x 9'4 (5.13m x 2.85m)
 Bedroom 2 : 10'2 x 8'10 (3.10m x 2.69m)
 Bedroom 3 : 10'2 x 7'8 (3.10m x 2.34m)
 Bathroom

OUTSIDE

Allocated Parking
 Rear Garden

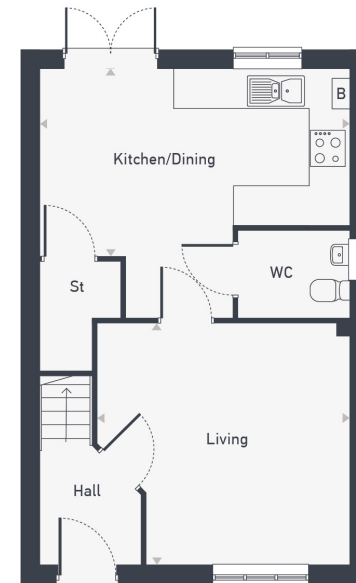

Call Shared Ownership - 01403 602681 ■ cubittandwest.co.uk

- If buying to let, the energy rating will need to be improved to at least 'E' rating before you can let the property
- Legal advice should be taken to verify fixtures/fittings, planning, alterations and/or lease details
- Appliances & services are untested, dimensions are approximate and floor plans are not to scale



2430024A/20251120/KCE/KCE